

FARM-TO-MARKET 1008  
(100' R.O.W.)  
T. & N.O. RAILROAD  
(100' R.O.W.)

"POINT OF BEGINNING"  
X=3271534.65  
Y=13953039.44

RESOLVE OF 33.75 ACRES, TRACT 2  
VOL. 78, PG. 812, D.R.L.C., TX  
(CALLED N 89°48'40" E)  
N 87°43'03" E 617.58'  
IRON ROD AT 32023'

NUMBER TO OBSERVE OR SET OUT  
AT THE END OF THIS SURVEY

LIBERTY TOWN SOUTH LEAGUE  
ABSTRACT 358  
LAKE

10.258 ACRES  
VOL. 1268, PG. 332, O.P.R.L.C., TX  
S 02°07'57" E 562.80'  
(CALLED S 00°02'20" E 564.27')

8.273 ACRES  
CALLED BURNETT FORESTRY, LLC  
L.C.C.F. NO(S) 2007007755, O.P.R.L.C., TX

8.36 ACRES

0.10 ACRES  
OUT OF A CALLED 7.813 ACRES  
JEFFREY W. BURNETT  
L.C.C.F. NO(S) 2007007752, O.P.R.L.C., TX

7.71 ACRES  
OUT OF A CALLED 7.813 ACRES  
JEFFREY W. BURNETT  
L.C.C.F. NO(S) 2007007752, O.P.R.L.C., TX

APPROXIMATE LOCATION OF  
THE 100 YEAR FLOOD PLAIN  
FROM NO. 480440 0003 B,  
DATED 09-30-1998

N 24°07'30" E 139.02'  
N 02°14'05" W 403.42'  
N 79°19'01" W 382.43'  
(CALLED N 77°07'29" W)

S 78°15'11" W 309.81'  
(CALLED S 80°27'10" W 309.93')

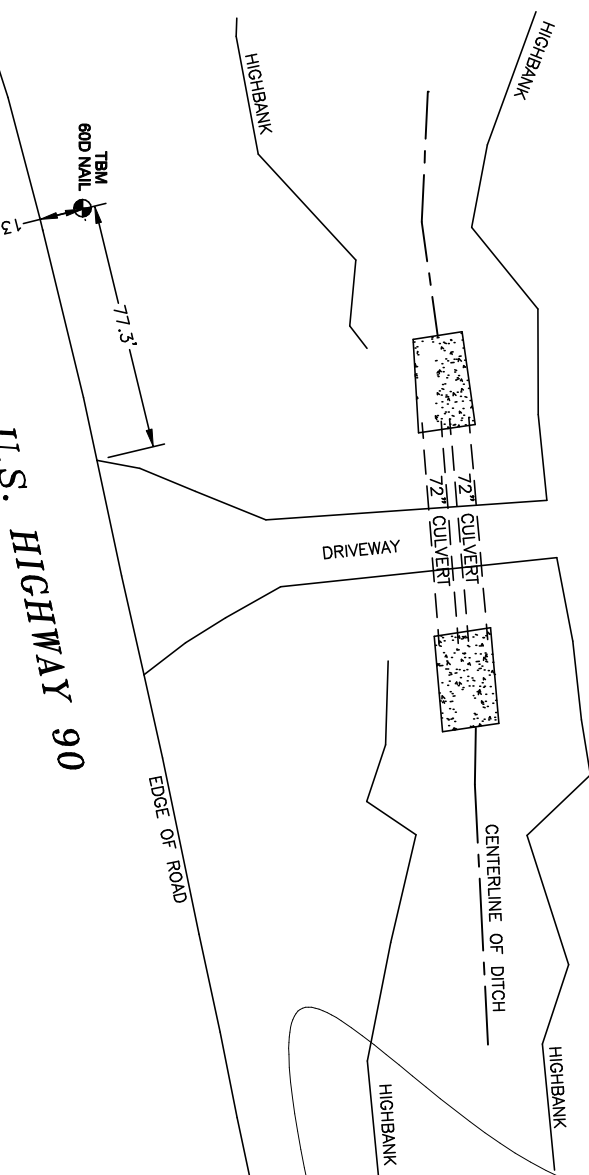

ZONE "X"

ZONE "AE"

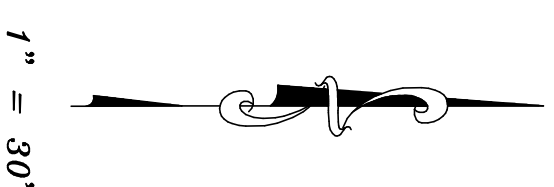

**LEGEND**  
O.P.R.L.C. = OFFICIAL PUBLIC RECORD  
D.R.L.C. = DEED RECORD OF LIBERTY COUNTY  
L.C.C.F. NO(S) = LIBERTY COUNTY CLERK'S  
VOL. = VOLUME  
PG. = PAGE  
[Symbol] = CONCRETE

**NOTES:**

1. FLOOD ZONE DETERMINED BY GRAPHIC PLOTTING ONLY. FLOOD INFORMATION PROVIDED HEREON IS BASED ON SCALING THE LOCATION TO THE SUBJECT TRACT ON THE FLOOD INSURANCE RATE MAPS. THE PROPERTY IS NOT INSURED. FLOOD INSURANCE RATES ONLY AND IS NOT INTENDED TO IDENTIFY SPECIFIC FLOODING CONDITIONS. WE DO NOT ASSUME RESPONSIBILITY FOR EXACT DETERMINATION.
2. SUBJECT PROPERTY PARTIALLY LIES WITHIN THE 100 YEAR FLOOD PLAIN AND IS "X" & "AE" DATED 09-30-1998. FIRM PANEL NO. 480440 0003B.
3. THIS SURVEY DOES NOT CONSTITUTE A TITLE CURATIVE SURVEY. ANY UNRECORDED INTERESTS WITHOUT THE BENEFIT OF A TITLE COMMITMENT AND RESTRICTIVE COVENANTS, ENCUMBRANCES AND AGREEMENTS OF RECORD.
4. ALL CALLED BEARINGS ARE RECORD BEARINGS AND COORDINATE SYSTEM SOUTH CENTRAL ZONE 1983 DATUM.
5. ALL CORNERS ARE PROPERLY MARKED WITH 1/2" CAPTED IRON RODS MARKED HEAT LAND UNLESS OTHERWISE NOTED.

JOB NO. 207447-3  
BUYER: JEFFREY BURNETT  
ADDRESS: FARM-TO-MARKET 1008  
DAYTON, TEXAS 77535

**H & H** PROFESSIONAL LAND SERVICES  
10303 1/2 Eagle Drive, Suite A  
Mont Belvieu, TX 77850  
Tel: (281) 355-5722  
Fax: (281) 355-5722

1. HOWARD L. MARTIN, REGISTERED PROFESSIONAL LAND SURVEYOR NO. 4078 DECLARE THAT THIS PLAT DENOTES THE RESULT OF AN ON THE GROUND SURVEY OF A 8.36 ACRE TRACT OF LAND SITUATED IN THE LIBERTY TOWN SOUTH LEAGUE, ABSTRACT 358, LIBERTY COUNTY, TEXAS AND BEING 0.10 ACRES OUT OF AND A PART OF THE CALLED 7.813 ACRES CONVEYED TO JEFFREY W. BURNETT RECORDED BY DEED IN TEXAS AND ALL OF A CALLED 8.273 ACRES CONVEYED TO BURNETT FORESTRY, LLC AND RECORDED BY DEED IN LIBERTY COUNTY CLERK'S FILE NO(S) 2007007755 OF THE OFFICIAL PUBLIC RECORDS OF LIBERTY COUNTY, TEXAS SAID 8.36 ACRES BEING MORE PARTICULARLY DESCRIBED BY ATTACHED METES AND BOUNDS.