



KINGS HARBOR

WATERFRONT VILLAGE



- 20 acre site strategically located in the densely populated and affluent Kingwood-Atascocita trade area
- Only commercial waterfront site in the trade area
- Great accessibility and visibility to West Lake Houston Parkway
- Unique, enticing architectural design with pedestrian fountain features, beautiful walkways and community gathering spots
- Affluent demographic profile with strong disposable income

SITE MAP

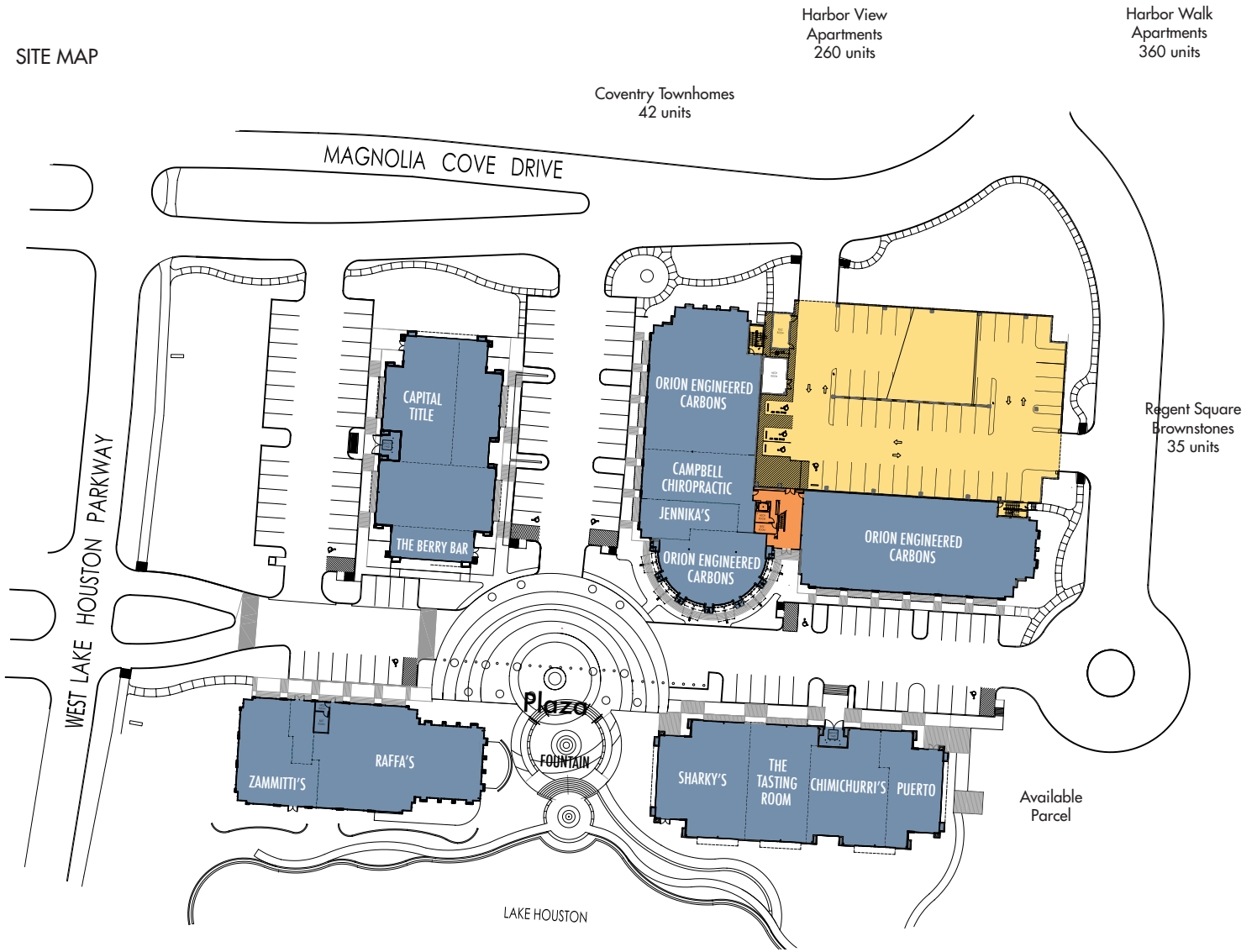

COMPARATIVE DEMOGRAPHICS

	Population (3 mile)	Median HH Income	Average HH Income over \$75,000	Population with Average HH Income over \$75,000
Kings Harbor (3 mile)	70,190	105,835	71.6%	50,256
LaCenterra (Katy)	69,121	114,146	42.7%	29,515
Market Street The Woodlands	57,887	76,635	52.6%	30,449
Pearland Town Center	35,437	99,032	66.5%	23,566
Sugar Land Town Square	77,441	111,571	70.1%	54,286
Vintage Park (Champions)	85,173	90,966	60.9%	51,870
Average	65,875	100,076	60.7%	40,008

TRAFFIC COUNTS

West Lake Houston Parkway, South of Kingwood Drive 32,930 cars per day
 West Lake Houston Parkway, North of Kingwood Drive 30,720 cars per day